



METALWORKING



ETP HYDRO-FIX Orientation kit



OPERATING MANUAL

<i>Description</i>	<i>Part no.</i>
ETP HYDRO-FIX Orientation kit	664180

This orientation kit allows you to easily and with precision set your tool bar outside of the machine and transfer the settings to your installed ETP HYDRO-FIX clamping unit.

Parts list

<i>Position</i>	<i>Description</i>
1	Fixture Ø 12 mm. Incl. Stop plug with set screw
Orientation discs	
2	Orientation disc Ø 4 mm.
3	Orientation disc Ø 6 mm.
4	Orientation disc Ø 8 mm.
5	Orientation disc Ø 12 mm.
Reduction sleeves	
6	HS 12 / 4 mm.
7	HS 12 / 6 mm.
8	HS 12 / 8 mm.
Wrenches & Accessories	
9	Torque wrench 0.45 Nm (2.5 mm Hex)
10	Allen key (1.5 mm)
11	Screw M3x8

VIEW VIDEO INSTRUCTIONS

ETP HYDRO-FIX Orientation kit Overview



Scan the code to review an overview of the included parts in your orientation kit.



Setting your tool when using a Round tool bar

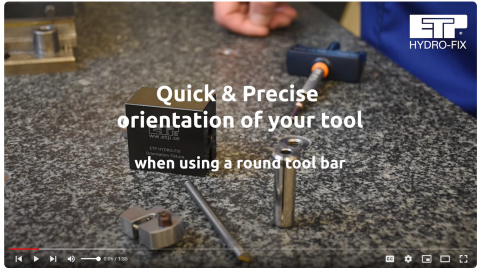

Scan the code to see the complete procedure how to set your round tool bar.



Setting your tool when using an EasyFix tool bar

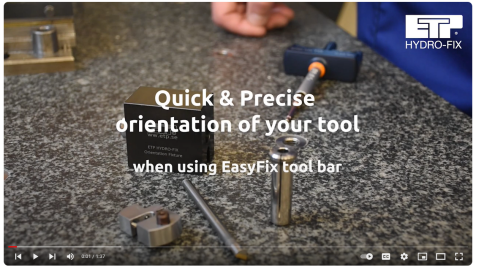

Scan the code to see the complete procedure how to set your EasyFix tool bar.





ETP Transmission AB

Box 1120, SE-581 11, Linköping, Sweden

Phone: +46 (0)13 24 71 00

E-mail: info@etp.se, Internet: www.etp.se